

ASSEMBLY INSTRUCTIONS FOR RAM SEAT-MATE

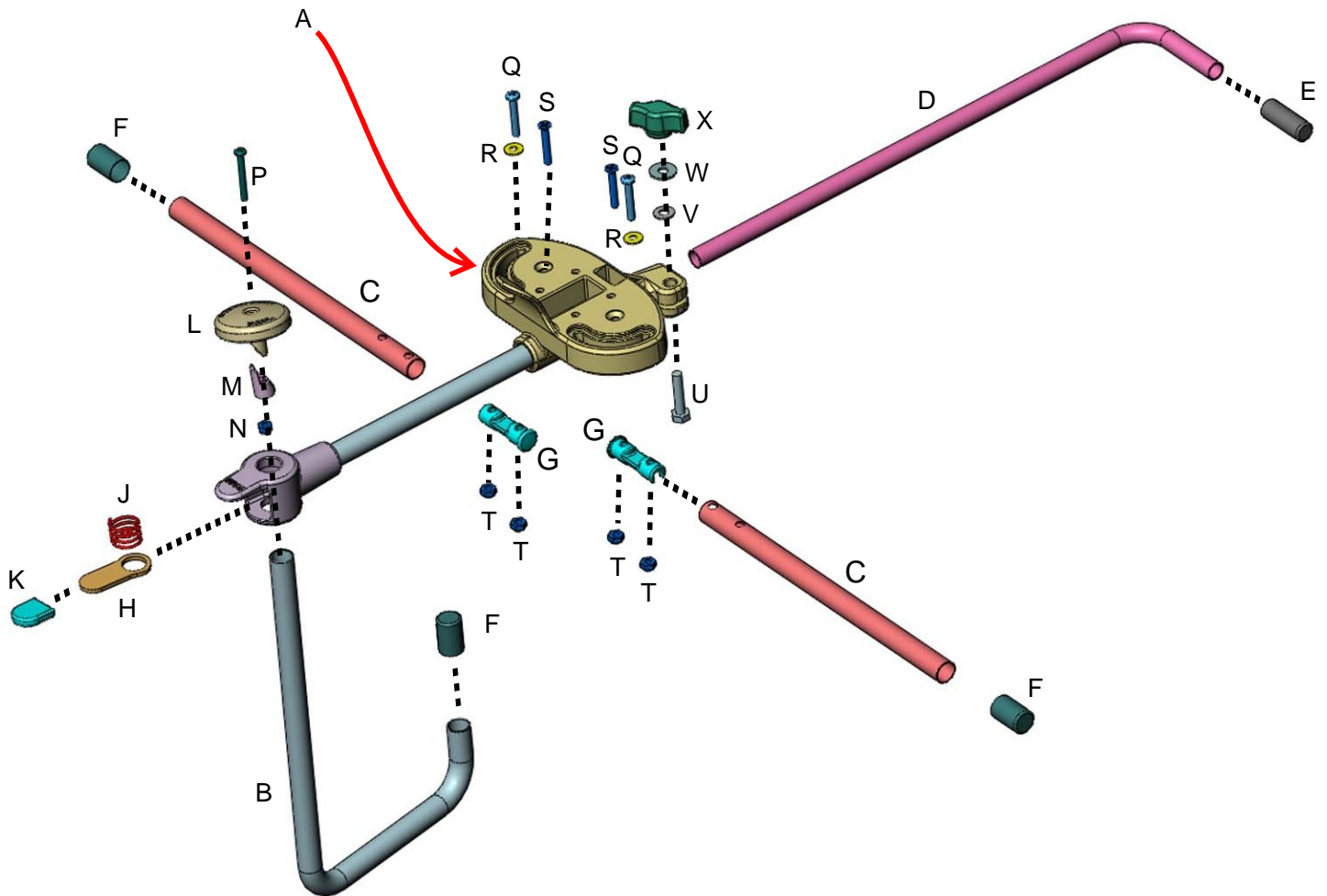

- A: 1 QTY. MAIN PLASTIC BASE PLATE WITH FRONT TUBE ASSEMBLY
- B: 1 QTY. FRONT VERTICAL TUBE
- C: 2 QTY. SIDE SWING TUBES
- D: 1 QTY. REAR SEAT BACK TUBE
- E: 1 QTY. 1/2" ID VINYL CAP
- F: 3 QTY. 5/8" ID VINYL CAPS
- G: 2 QTY. SIDE SWING TUBE NUT POCKET CONNECTORS
- H: 1 QTY. THUMB WEDGE PLATE
- J: 1 QTY. THUMB WEDGE SPRING
- K: 1 QTY. 3/4" X 1" THUMB WEDGE VINYL CAP
- L: 1 QTY. HAND LIFT KNOB
- M: 1 QTY. HAND LIFT KNOB WEDGE
- N: 1 QTY. #8-32 NYLOCK NUT
- P: 1 QTY. #8-32 X 1 1/2" LONG MACHINE SCREW
- Q: 2 QTY. #10-24 X 1 1/4" LONG PAN HEAD MACHINE SCREWS
- R: 2 QTY. #10 FLAT WASHERS
- S: 2 QTY. #10-24 X 1 1/4" LONG FLAT HEAD MACHINE SCREWS
- T: 4 QTY. #10-24 NYLOCK NUTS
- U: 1/4"-20 X 1" LONG HEX BOLT
- V: 1 QTY. 1/4" STEEL FLAT WASHER
- W: 1 QTY. 1/4" PLASTIC FLAT WASHER
- X: 1 QTY. T-KNOB

**Never use mobile computing or
communication equipment while the
vehicle is in motion!**

INSTALLATION INSTRUCTIONS FOR RAM SEAT-MATE

Videos and instructions for assembly and use may also be found at: www.ram-mount.com



STEP 1 Slide Rear Seat Back Tube (D) under seat back and turn tube so that bent leg is facing down.



STEP 2 Turn and position Front Vertical Tube (B) under front of seat.



STEP 3 Slide both Side Swing Tubes (C) till they stop or until they are approx. 90 degrees to the Rear Seat Back Tube.



STEP 4 Make certain that Rear Seat Back Tube (D) and Front Vertical Tube (B) are snug against their respective surfaces, then tighten T-Knob (X).



STEP 5 Using one hand to press down on Front Tube (A) pull up on Hand Lift Knob (L) until Seat-Mate is secure on seat.



STEP 5 Loop the seat belt around the seat belt strap lug as shown and attach your appropriate RAM Mount.



Your RAM Seat-Mate may come with a personal travel bag, if so we recommend removing the Rear Seat Back Tube (D) prior to fitting it into the travel bag (as shown). Typically the travel bag will hold the entire RAM Mount System including the Seat-Mate, RAM Mount and a RAM Tough Tray (not shown) along with your laptop or electronic device (also not shown).



RAM Seat-Mate may be used in a wide variety of applications including but not limited to Vehicles, Boats, Aircraft, Chairs, Buses, etc.



PLANES



BOATS

Never use mobile computing or communication equipment while the vehicle is in motion!

National Products Inc. 8410 Dallas Ave. S. Seattle, WA 98108

Phone: (206) 763-8361 Fax: (206) 763-9615

Web: www.ram-mount.com E-mail: staff@ram-mount.com #RMR-INS-SM1